



ASKING PRICE / Reduced To

£155,000



THE DETAILS

 2  1  1



9 Fuchsia Lane
Governors Hill, Douglas
Reduced To £155,000

call in today or visit www.blackgracecowley.com for more details

e: info@blackgracecowley.com | **w:** blackgracecowley.com | **t:** +44 (0) 1624 645 555

a: 51 Victoria Street, DOUGLAS, Isle of Man, IM1 2LD



PROPERTY DETAILS FOR

9 Fuchsia Lane, Governors Hill, Douglas

THE DESCRIPTION

- Ground floor purpose built apartment
- Convenient position with excellent local amenities
- Hall, Lounge with open plan Kitchen
- 2 double Bedrooms, Bathroom
- Gas central heating with replacement boiler
- uPVC double glazing
- Car parking space, shared gardens
- Occupation restricted to over 50's
- No onward chain

THE PROPERTY

DIRECTIONS

Leave Douglas via the promenade and at the Villa Marina turn left at the traffic lights onto Broadway and then continue through the next two sets of lights onto Ballanard Road and then right at the roundabout onto Johnny Watterson's Lane. Continue along and turn right into Governors Hill via Hailwood Avenue. Continue past the shops, turn left into Fuchsia Lane and then follow the road around to the left where the property is identified by our For Sale board.

COVERED ENTRANCE

HALL

Shelved cupboard.

LOUNGE (APPROX 16'3 X 10'10)

Open plan through to:

KITCHEN (APPROX 9'9 X 9'0)

Refitted with a range of white gloss fronted base, wall and drawer units. Matching worksurfaces with tiling behind. Ceramic hob. Filter hood. Space for cooker. Tiled floor. Door to the rear.

BEDROOM 1 (APPROX 12'0 X 10'2)

Walk-in wardrobe.

e: info@blackgracecowley.com | w: blackgracecowley.com | t: +44 (0) 1624 645 555

a: 51 Victoria Street, DOUGLAS, Isle of Man, IM1 2LD



PROPERTY DETAILS FOR

9 Fuchsia Lane, Governors Hill, Douglas

BEDROOM 2 (APPROX 11'0 X 9'6)

Fitted wardrobe.

BATHROOM (APPROX 10'4 X 5'9)

Coloured suite comprising bath with plumbed in shower over, wash hand basin and toilet. Tiled walls. Towel rail/radiator. Shelved linen cupboard.

OUTSIDE

Communal gardens and allocated car parking space (Number 17).

TENURE

Leasehold for the term of 125 years commencing November 1996.

SERVICE CHARGE

Approximately £75 per month payable.

SERVICES

All mains services are installed. Gas fired central heating with replacement Alpha boiler.

POSSESSION

Vacant possession on completion of purchase.

VIEWINGS

By appointment through the Agent, Black Grace Cowley.

e: info@blackgracecowley.com | **w:** blackgracecowley.com | **t:** +44 (0) 1624 645 555

a: 51 Victoria Street, DOUGLAS, Isle of Man, IM1 2LD

FLOORPLAN

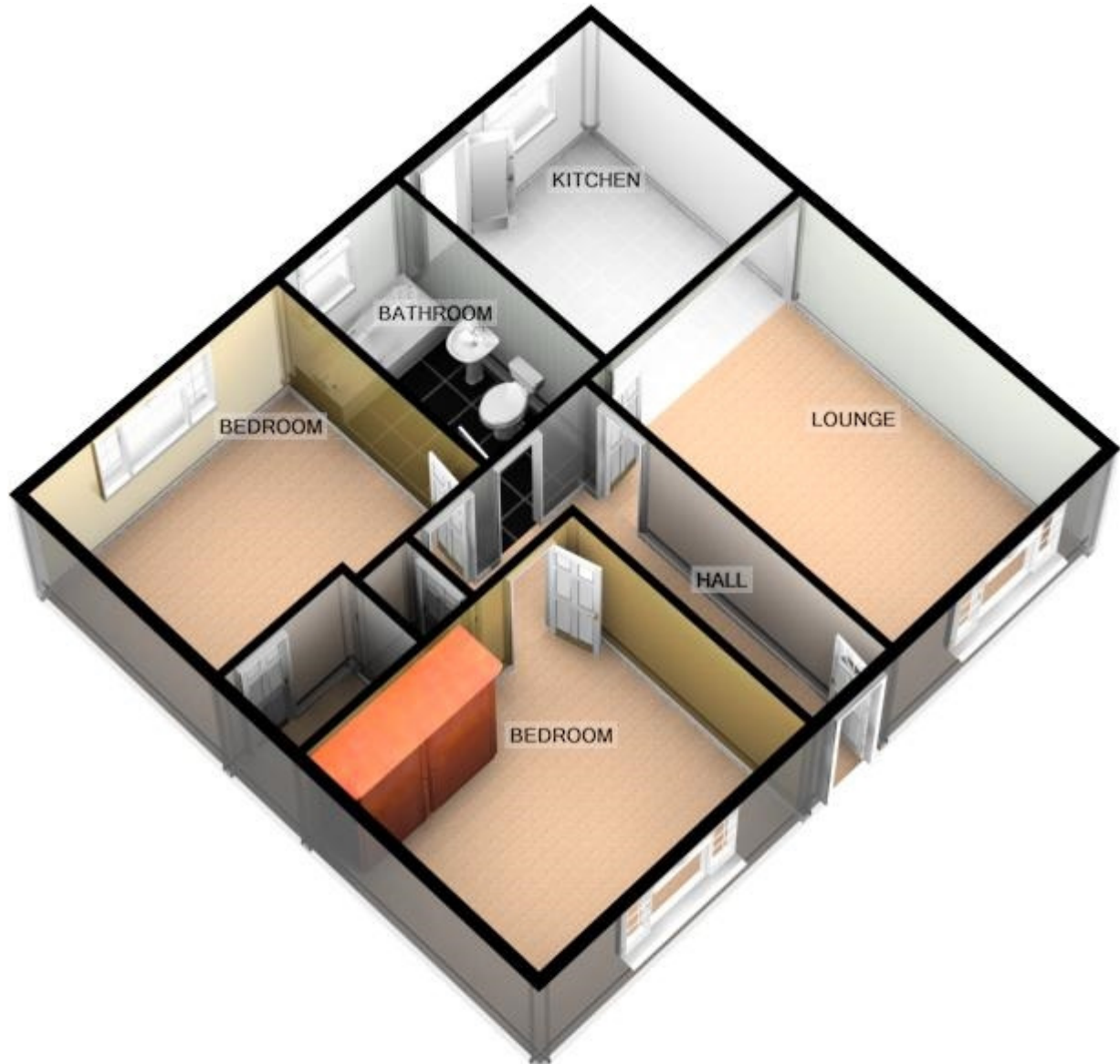

For illustrative purposes only. Decorative finishes, fixtures, fittings and furnishings do not represent the current state of the property. Measurements are approximate. Not to scale
Made with Metropix ©2017