



ASKING PRICE

£150,000

THE DETAILS



24 Market Street

Peel

£150,000

call in today or visit www.blackgracecowley.com for more details

e: peel@blackgracecowley.com | w: blackgracecowley.com | t: +44 (0) 1624 845 696

a: 9 Atholl Place, PEEL, Isle of Man, IM5 1HE

PROPERTY DETAILS FOR
24 Market Street, Peel



PROPERTY DETAILS FOR
24 Market Street, Peel





PROPERTY DETAILS FOR 24 Market Street, Peel

THE DESCRIPTION

- Traditional end terrace cottage
- Located within walking distance to the promenade, shops and amenities
- Lounge, Kitchen, 2 Bedrooms, Bathroom and Attic Room
- Fitted white bespoke shutter blinds
- Rear access to the property
- Gas fire central heating
- No onward chain

THE PROPERTY

DIRECTIONS

From Peel Market Place turn down Market Street towards the promenade and beach, and number 24 will be found on the right hand side at the first corner.

ACCOMMODATION

ENTRANCE VESTIBULE

Stairs to first floor.

LOUNGE (*APPROX 14'4 X 12'8*)

Multi-fuel burner. Exposed beamed ceiling. Fitted shutter blinds.

KITCHEN (*APPROX 12'1 X 10'9*)

Fitted with a range of white 'Shaker' style wall and base units incorporating a stainless steel sink unit with mixer tap, ceramic hob with electric oven and extractor over. Plumbing for washing machine. Exposed beamed ceiling. Understairs storage area with access to rear walkway. Wood effect laminate flooring. Fitted shutter blinds.

FIRST FLOOR

Landing. Door to enclosed stairs leading to Attic Room.



PROPERTY DETAILS FOR
24 Market Street, Peel

BEDROOM 1 (APPROX 14'5 X 11'3)

Built-in cupboard providing storage and housing gas fired central heating boiler. Fitted shutter blinds.

BEDROOM 2 (APPROX 9'0 X 8'9)

Fitted shutter blinds.

BATHROOM (APPROX 6'8 X 4'9)

Fitted with a white suite comprising bath with electric shower over and screen, wash hand basin and toilet. Towel rail and shelving. Part tiled walls.

ATTIC ROOM (APPROX 19'10 X 14'8)

Velux window.

SERVICES

All mains services are installed. Gas fired central heating.

TENURE

Freehold.

POSSESSION

Vacant possession on completion of purchase.

VIEWINGS

By appointment through the Agent, Black Grace Cowley.

FLOORPLAN

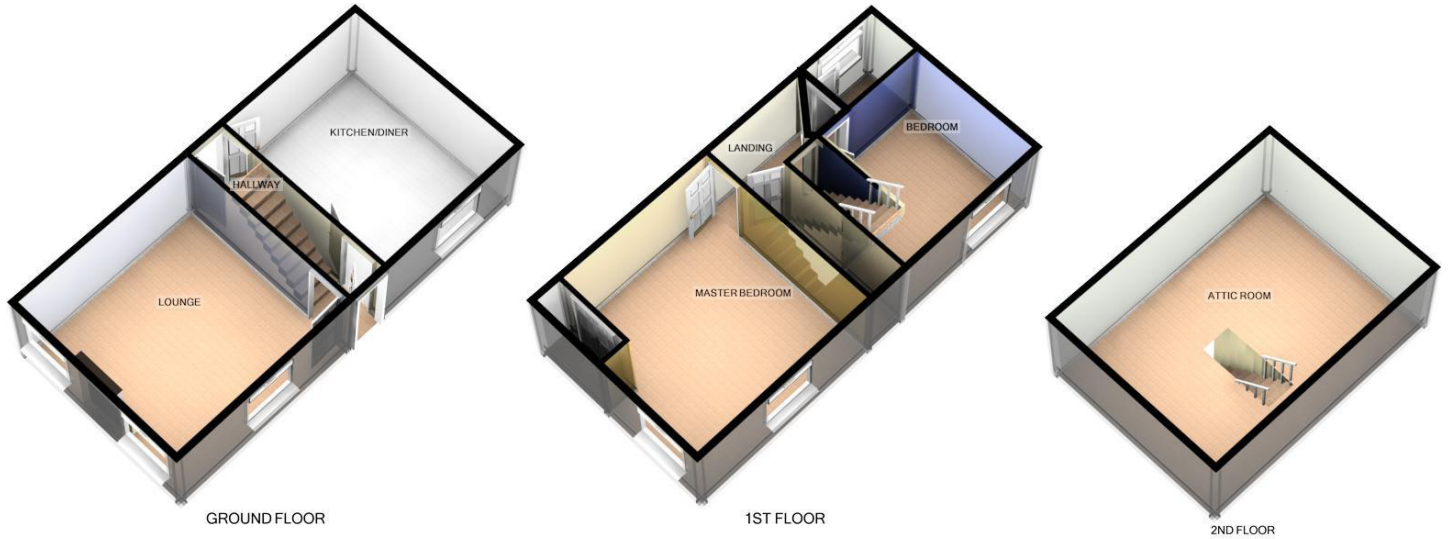

For illustrative purposes only. Decorative finishes, fixtures, fittings and furnishings do not represent the current state of the property. Measurements are approximate. Not to scale
Made with Metropix ©2018