



ASKING PRICE

£219,950



## THE DETAILS

 5     1     2

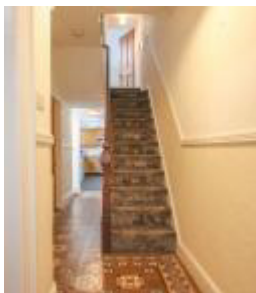

26 Princes Street

Douglas

£219,950

call in today or visit [www.blackgracecowley.com](http://www.blackgracecowley.com) for more details

e: [hello@blackgracecowley.com](mailto:hello@blackgracecowley.com) | w: [blackgracecowley.com](http://blackgracecowley.com) | t: +44 (0) 1624 645 555

a: 51 Victoria Street, DOUGLAS, Isle of Man, IM1 2LD

PROPERTY DETAILS FOR  
26 Princes Street, Douglas





PROPERTY DETAILS FOR  
26 Princes Street, Douglas



PROPERTY DETAILS FOR  
**26 Princes Street, Douglas**





PROPERTY DETAILS FOR

## 26 Princes Street, Douglas

### THE DESCRIPTION

- Traditional mid terraced town house
- Convenient position close to the town centre
- Hall, Lounge open plan to Dining Room, Kitchen
- 5 Bedrooms, spacious Bathroom and Attic
- Gas fired central heating and double glazing
- No onward chain

### THE PROPERTY

#### DIRECTIONS

Leave Douglas centre via Bucks Road and continue beyond Circular Road turning next left onto Princes Street where the property is approximately halfway along on the right hand side.

#### VESTIBULE ENTRANCE

uPVC double glazed front door. Original tiled floor and coved ceiling.

#### HALLWAY

Original tiled floor, coved ceiling and corbels. Stairs to the first floor with understairs cupboard. Door to the yard.

#### LOUNGE (APPROX 12'10 X 12'0)

Original fireplace and coved ceiling. Laminate wood floor covering. Open plan through to:

#### DINING ROOM (APPROX 13'0 X 9'0)

Laminate wood floor covering.

#### KITCHEN (APPROX 15'0 X 8'0)

Fitted base, wall and drawer units, matching work surfaces with tiling behind. 1½ bowl single drainer stainless steel sink unit. Electric oven, gas hob and filter hood. Plumbing for automatic washing machine.

#### FIRST FLOOR

e: [hello@blackgracecowley.com](mailto:hello@blackgracecowley.com) | w: [blackgracecowley.com](http://blackgracecowley.com) | t: +44 (0) 1624 645 555

a: 51 Victoria Street, DOUGLAS, Isle of Man, IM1 2LD



PROPERTY DETAILS FOR

## 26 Princes Street, Douglas

### LANDING

Stairs to the second floor.

### BEDROOM (APPROX 16'3 X 12'7)

Coved ceiling.

### BEDROOM (APPROX 12'8 X 10'4)

### BATHROOM (APPROX 15'3 X 8'1)

Spacious family bathroom fitted with a corner bath, large shower enclosure with plumbed in shower, wash hand basin and toilet.

### W.C.

Separate W.C.

### SECOND FLOOR

### LANDING

Stairs to the attic. Understairs store.

### BEDROOM (APPROX 12'7 X 9'6)

Original fireplace.

### BEDROOM (APPROX 12'9 X 9'1)

Original fireplace.



PROPERTY DETAILS FOR

## 26 Princes Street, Douglas

### BEDROOM (APPROX 9'5 X 6'6)

### ATTIC ROOM (APPROX 15'3 X 8'4)

Useful attic room with restricted headroom. Skylight window and eaves access.

### OUTSIDE

Pavement frontage and an enclosed rear yard.

### SERVICES

All main services are installed.

### TENURE

The Tenure is Freehold.

### POSSESSION

Vacant possession on completion of purchase.

### VIEWINGS

By appointment through the agent, Black Grace Cowley.

## FLOORPLAN

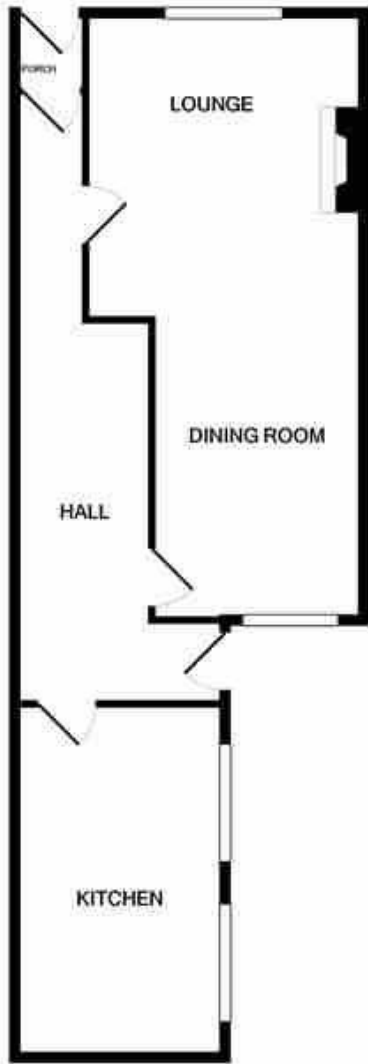

GROUND FLOOR



1ST FLOOR

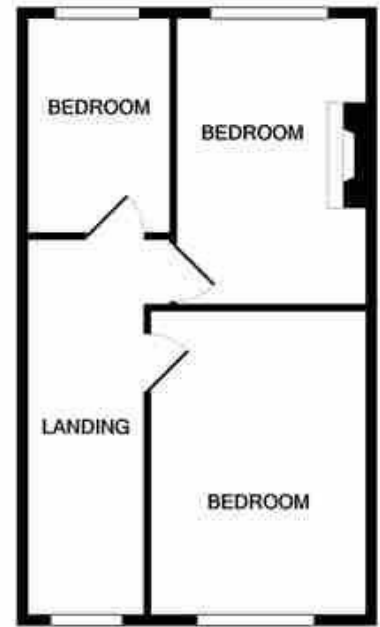

2ND FLOOR

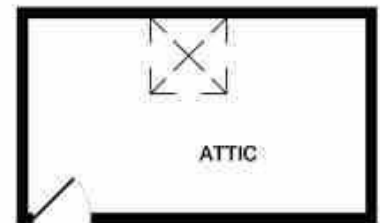

3RD FLOOR

Whilst every attempt has been made to ensure the accuracy of the floor plan contained here, measurements of rooms, windows, rooms and any other items are approximate and no responsibility is taken for any error, omission, or mis-statement. This plan is for illustrative purposes only and should be used as such by any prospective purchaser. The services, systems and appliances shown have not been tested and no guarantee as to their operability or efficiency can be given.  
Made with Miroviz ©2020





PROPERTY DETAILS FOR

# 26 Princes Street, Douglas

## Disclaimer

These particulars are for information purposes only and do not constitute or form any contract nor should any statement contained herein be relied upon as a representation of fact.

Neither the vendor nor Black Grace Cowley (the firm), nor any officer or employee of the firm accept liability or responsibility for any statement contained herein.

The vendor does not by these particulars, nor does the firm, nor does any officer or any employee of the firm have any authority to make or give any representation or warranty whatsoever as regards the property or otherwise. It is the sole responsibility of any person interested in the property described in these particulars to make all proper enquiries and searches to verify the description of the property and all other particulars herein.

**e:** [hello@blackgracecowley.com](mailto:hello@blackgracecowley.com) | **w:** [blackgracecowley.com](http://blackgracecowley.com) | **t:** +44 (0) 1624 645 555

**a:** 51 Victoria Street, DOUGLAS, Isle of Man, IM1 2LD