



ASKING PRICE

£365,000

THE DETAILS

 2  3  1



Apartment 25, Quay West
Douglas
£365,000

call in today or visit www.blackgracecowley.com for more details

e: hello@blackgracecowley.com | w: blackgracecowley.com | t: +44 (0) 1624 645555

a: 51 Victoria Street, DOUGLAS, Isle of Man, IM1 2LD

Apartment 25, Quay West, Douglas



e: hello@blackgracecowley.com | w: blackgracecowley.com | t: +44 (0) 1624 645555

a: 51 Victoria Street, DOUGLAS, Isle of Man, IM1 2LD





Apartment 25, Quay West, Douglas



Apartment 25, Quay West, Douglas



e: hello@blackgracecowley.com | w: blackgracecowley.com | t: +44 (0) 1624 645555

a: 51 Victoria Street, DOUGLAS, Isle of Man, IM1 2LD

THE DESCRIPTION

- Ground floor modern purpose built apartment in Quay West
- Walking Distance Of Marina, Bars And Restaurants
- Open plan Living space, Kitchen area and Breakfast Area
- 2 Bedrooms, 2 En Suites and additional Wet Room
- Private patio and communal courtyard
- 2 Allocated secure underground parking spaces (37 & 38)
- Electric underfloor heating

THE PROPERTY

Black Grace Cowley are delighted to offer this well presented ground floor purpose built apartment in Quay West, Douglas. Upon entering the apartment, the Entrance Hall houses the utility cupboard fitted with a Megaflow and plumbed for washing machine. Additionally there are 2 built in Storage Cupboards/Cloakrooms. Open plan Lounge, fitted Kitchen area with integrated appliances and Dining area. The Master Bedroom with fitted double mirrored wardrobes and modern En Suite Bathroom. The second Bedroom with En Suite Wet Room is also fitted with mirrored wardrobes and sliding patio doors providing access to the private sun terrace. Additional Wet Room with shower, WC, vanity wash hand basin and heated towel rail.

Quay West is within easy and level walking distance of Portofino Restaurant (within the scheme) the Marina, bars, restaurants and Tesco. The property has two secure underground car parking spaces No. 37 and 38. Remainder of a 999 year lease. Mains water, electricity and drainage. Electric underfloor heating and double glazed. CAT 5 wiring. Service charge £2,136.00 per annum.

FLOORPLAN

GROUND FLOOR
929 sq.ft. (86.3 sq.m.) approx.

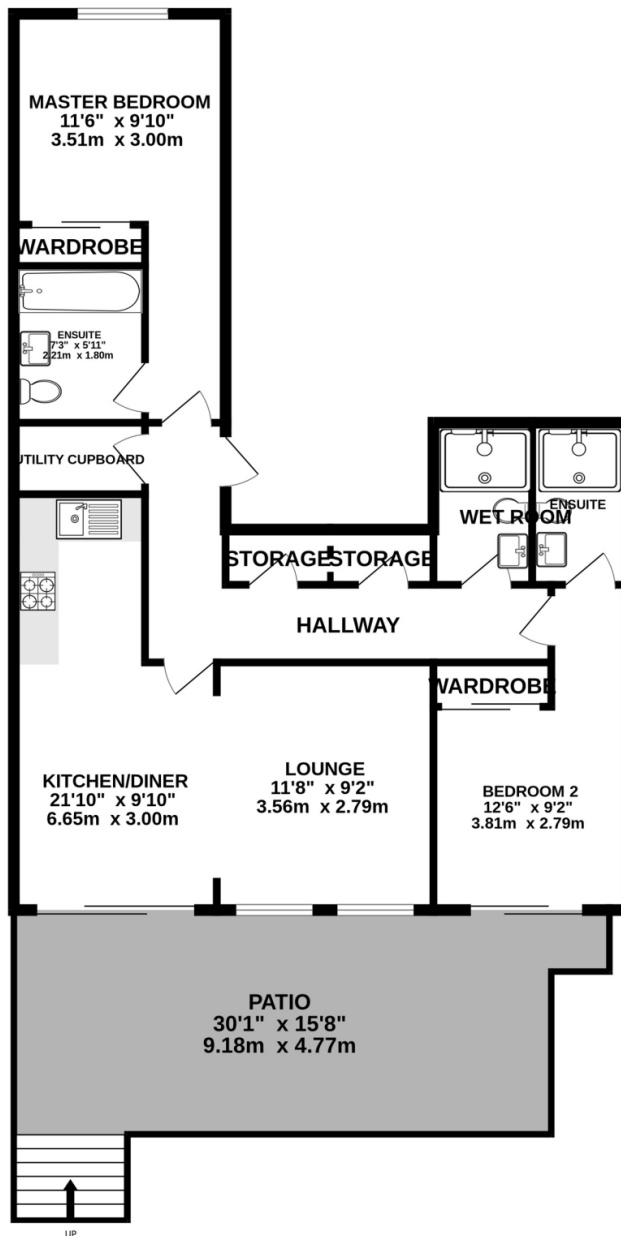

TOTAL FLOOR AREA : 929 sq.ft. (86.3 sq.m.) approx.

Whilst every attempt has been made to ensure the accuracy of the floorplan contained here, measurements of doors, windows, rooms and any other items are approximate and no responsibility is taken for any error, omission or mis-statement. This plan is for illustrative purposes only and should be used as such by any prospective purchaser. The services, systems and appliances shown have not been tested and no guarantee as to their operability or efficiency can be given.
Made with Metropix ©2023



PROPERTY DETAILS FOR

Apartment 25, Quay West, Douglas

Disclaimer

These particulars are for information purposes only and do not constitute or form any contract nor should any statement contained herein be relied upon as a representation of fact.

Neither the vendor nor Black Grace Cowley (the firm), nor any officer or employee of the firm accept liability or responsibility for any statement contained herein.

The vendor does not by these particulars, nor does the firm, nor does any officer or any employee of the firm have any authority to make or give any representation or warranty whatsoever as regards the property or otherwise. It is the sole responsibility of any person interested in the property described in these particulars to make all proper enquiries and searches to verify the description of the property and all other particulars herein.

e: hello@blackgracecowley.com | **w:** blackgracecowley.com | **t:** +44 (0) 1624 645555

a: 51 Victoria Street, DOUGLAS, Isle of Man, IM1 2LD