



ASKING PRICE

£349,950

## THE DETAILS

 5       1       3



20-22 Main Road  
Onchan  
£349,950

call in today or visit [www.blackgracecowley.com](http://www.blackgracecowley.com) for more details

e: [hello@blackgracecowley.com](mailto:hello@blackgracecowley.com) | w: [blackgracecowley.com](http://blackgracecowley.com) | t: +44 (0) 1624 645555

a: 51 Victoria Street, DOUGLAS, Isle of Man, IM1 2LD

PROPERTY DETAILS FOR  
**20-22 Main Road, Onchan**



e: [hello@blackgracecowley.com](mailto:hello@blackgracecowley.com) | w: [blackgracecowley.com](http://blackgracecowley.com) | t: +44 (0) 1624 645555

a: 51 Victoria Street, DOUGLAS, Isle of Man, IM1 2LD



PROPERTY DETAILS FOR  
**20-22 Main Road, Onchan**



e: [hello@blackgracecowley.com](mailto:hello@blackgracecowley.com) | w: [blackgracecowley.com](https://blackgracecowley.com) | t: +44 (0) 1624 645555

a: 51 Victoria Street, DOUGLAS, Isle of Man, IM1 2LD

PROPERTY DETAILS FOR  
**20-22 Main Road, Onchan**



e: [hello@blackgracecowley.com](mailto:hello@blackgracecowley.com) | w: [blackgracecowley.com](http://blackgracecowley.com) | t: +44 (0) 1624 645555

a: 51 Victoria Street, DOUGLAS, Isle of Man, IM1 2LD



PROPERTY DETAILS FOR  
**20-22 Main Road, Onchan**



**e:** [hello@blackgracecowley.com](mailto:hello@blackgracecowley.com) | **w:** [blackgracecowley.com](http://blackgracecowley.com) | **t:** +44 (0) 1624 645555

**a:** 51 Victoria Street, DOUGLAS, Isle of Man, IM1 2LD

## THE DESCRIPTION

- Spacious end of terrace family residence in the heart of Onchan Village
- Extensively renovated to an excellent standard by the current owners
- Spread over 3 floors
- Modern Kitchen, 2 Large Reception Rooms, Sun Room
- 5 Double Bedrooms, Family Bathroom
- Rear patio Courtyard
- Gas fired central heating, uPVC double glazed

## THE PROPERTY

Black Grace Cowley are delighted to offer this spacious end of terrace family residence located in the heart of Onchan Village. Extensively renovated by the current owners including; new roof, electric board & sockets, replastering in several rooms, attic Bedrooms fully insulated, new Kitchen and Bathroom. Upon entering the property, spacious entrance hall with staircase leading to the upper floors, storage cupboard beneath. Potential open plan Family Kitchen/Dining Room. To the rear, spacious Lounge with access to the Sun Room and newly renovated Kitchen with fitted wall and base units and integrated appliances. On the first floor, formal Lounge with feature central fireplace. 3 double Bedrooms and Family Bathroom with fitted bath tub, WC and wash hand basin. Staircase leads up to the 2nd floor where there are a further 2 double Bedrooms with Velux windows. Private and sunny patio courtyard. Gas fired central heating and uPVC double glazed throughout. Short walk to shops, amenities and main bus route in Onchan.

# PROPERTY DETAILS FOR 20-22 Main Road, Onchan

## FLOORPLAN

GROUND FLOOR  
874 sq.ft. (81.2 sq.m.) approx.

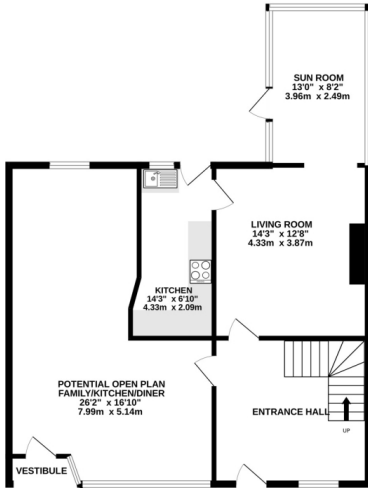

1ST FLOOR  
770 sq.ft. (71.5 sq.m.) approx.

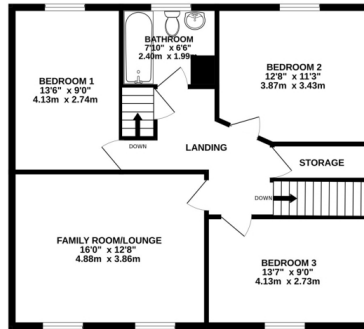

2ND FLOOR  
331 sq.ft. (30.7 sq.m.) approx.

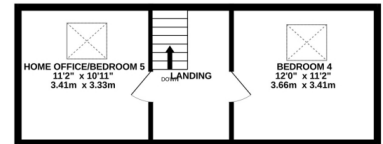

TOTAL FLOOR AREA: 1975 sq.ft. (183.5 sq.m.) approx.

Whilst every attempt has been made to ensure the accuracy of the floorplan contained here, measurements of doors, windows, rooms and any other items are approximate and no responsibility is taken for any error, omission or mis-statement. This plan is for illustrative purposes only and should be used as such by any prospective purchaser. The services, systems and appliances shown have not been tested and no guarantee as to their operability or efficiency can be given.  
Made with Metropix ©2023

**e:** [hello@blackgracecowley.com](mailto:hello@blackgracecowley.com) | **w:** [blackgracecowley.com](http://blackgracecowley.com) | **t:** +44 (0) 1624 645555

**a:** 51 Victoria Street, DOUGLAS, Isle of Man, IM1 2LD



PROPERTY DETAILS FOR

20-22 Main Road, Onchan

## Disclaimer

These particulars are for information purposes only and do not constitute or form any contract nor should any statement contained herein be relied upon as a representation of fact.

Neither the vendor nor Black Grace Cowley (the firm), nor any officer or employee of the firm accept liability or responsibility for any statement contained herein.

The vendor does not by these particulars, nor does the firm, nor does any officer or any employee of the firm have any authority to make or give any representation or warranty whatsoever as regards the property or otherwise. It is the sole responsibility of any person interested in the property described in these particulars to make all proper enquiries and searches to verify the description of the property and all other particulars herein.

**e:** [hello@blackgracecowley.com](mailto:hello@blackgracecowley.com) | **w:** [blackgracecowley.com](https://blackgracecowley.com) | **t:** +44 (0) 1624 645555

**a:** 51 Victoria Street, DOUGLAS, Isle of Man, IM1 2LD