



ASKING PRICE

£239,950



THE DETAILS



2



1



1



May's Cottage, 13 Victoria Place
Douglas
£239,950

call in today or visit www.blackgracecowley.com for more details

e: hello@blackgracecowley.com | w: blackgracecowley.com | t: +44 (0) 1624 645555

a: 51 Victoria Street, DOUGLAS, Isle of Man, IM1 2LD

May's Cottage, 13 Victoria Place, Douglas



e: hello@blackgracecowley.com | w: blackgracecowley.com | t: +44 (0) 1624 645555

a: 51 Victoria Street, DOUGLAS, Isle of Man, IM1 2LD



May's Cottage, 13 Victoria Place, Douglas





PROPERTY DETAILS FOR

May's Cottage, 13 Victoria Place, Douglas

THE DESCRIPTION

- Period Mid Terrace Property
- Situated in a quiet cul de sac in the heart of Douglas
- 2 Double Bedrooms, Modern Bathroom
- Open plan Living/Dining/Kitchen
- Gas fired central heating, uPVC double glazed
- South facing private rear courtyard, off road parking
- No onward chain

THE PROPERTY

Black Grace Cowley are delighted to offer this period mid terrace property in the heart of Douglas. Situated in a quiet cul de sac location, the property benefits from off street parking to the front. Double glazed front door leads into the open-plan bay-fronted bright Living space. Kitchen/Breakfast Room to the rear with modern wall and base units, laminate worktops and Victorian style tiled splash backs. Rear lobby leads into the modern Bathroom suite with walk in shower cubicle, bathtub, WC and wash hand basin. On the first floor, 2 good sized double Bedrooms. Exterior South facing courtyard with access to undercroft storage and rear gate leading onto Stanley Place. Property is an ideal first time purchase or as an investment. Property is offered for sale with no onward chain.

e: hello@blackgracecowley.com | **w:** blackgracecowley.com | **t:** +44 (0) 1624 645555

a: 51 Victoria Street, DOUGLAS, Isle of Man, IM1 2LD

FLOORPLAN

GROUND FLOOR
373 sq.ft. (34.7 sq.m.) approx.

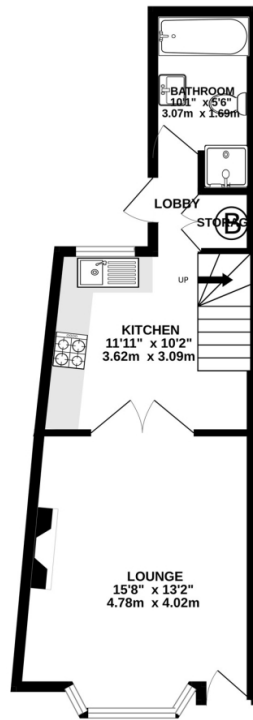

1ST FLOOR
291 sq.ft. (27.0 sq.m.) approx.

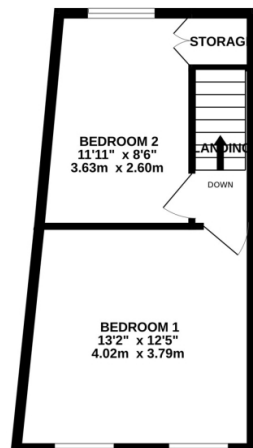

TOTAL FLOOR AREA : 664 sq.ft. (61.7 sq.m.) approx.

Whilst every attempt has been made to ensure the accuracy of the floorplan contained here, measurements of doors, windows, rooms and any other items are approximate and no responsibility is taken for any error, omission or mis-statement. This plan is for illustrative purposes only and should be used as such by any prospective purchaser. The services, systems and appliances shown have not been tested and no guarantee as to their operability or efficiency can be given.
Made with Metropix ©2023



PROPERTY DETAILS FOR

May's Cottage, 13 Victoria Place, Douglas

Disclaimer

These particulars are for information purposes only and do not constitute or form any contract nor should any statement contained herein be relied upon as a representation of fact.

Neither the vendor nor Black Grace Cowley (the firm), nor any officer or employee of the firm accept liability or responsibility for any statement contained herein.

The vendor does not by these particulars, nor does the firm, nor does any officer or any employee of the firm have any authority to make or give any representation or warranty whatsoever as regards the property or otherwise. It is the sole responsibility of any person interested in the property described in these particulars to make all proper enquiries and searches to verify the description of the property and all other particulars herein.

e: hello@blackgracecowley.com | **w:** blackgracecowley.com | **t:** +44 (0) 1624 645555

a: 51 Victoria Street, DOUGLAS, Isle of Man, IM1 2LD