



ASKING PRICE

£575,000

THE DETAILS



4



3



3



Emscote, Highfield Drive

Baldrine

£575,000

call in today or visit www.blackgracecowley.com for more details

e: hello@blackgracecowley.com | w: blackgracecowley.com | t: +44 (0) 1624 645555

a: 51 Victoria Street, DOUGLAS, Isle of Man, IM1 2LD







PROPERTY DETAILS FOR
Emscote, Highfield Drive, Baldrine





THE DESCRIPTION

- Detached Dormer Bungalow situated in an elevated position
- Countryside and distant sea views from the front and rear
- 4 Bedrooms, 2 En suites, Family Shower Room
- 3 Reception Rooms, Modern fitted Kitchen
- Block paved driveway providing off road parking
- Lawned rear gardens with large summerhouse
- uPVC double glazed and Oil fired central heating

THE PROPERTY

Black Grace Cowley are pleased to offer this Detached Dormer Bungalow situated in a quiet position in Baldrine. Block paved driveway providing off road parking for several vehicles. Porch to the front of the property leads into the entrance hall. To the left, spacious living room with feature multifuel fireplace, opening onto the bright Conservatory. Dining Room with open staircase leading to the first floor. Modern fitted Kitchen with white high gloss wall and base units, black granite worktops and integrated appliances. Separate Utility Room with plumbing for a washing machine and space for a tumble dryer. Master Bedroom with fitted wardrobe storage; en suite comprising bathtub, WC and wash hand basin. Bedrooms 2 and 3 are located off the Inner hall/Snug. Bedroom 2 complemented with an en suite Shower Room. Bedroom 4 is on the upper floor with eaves storage and Velux Windows providing stunning countryside views to Snaefell. Additional Family Shower room on the ground floor. Externally, large lawned rear garden with paved terrace area. Summerhouse at the top of the garden, benefits from distant sea and countryside views. Additional timber shed for storage. Oil fired central heating and uPVC double glazed throughout.

DIRECTIONS

Travelling from Onchan into Baldrine, take the left turning into Baldrine Road after the Baldrine Methodist Hall. Proceed up the road and take the second right into Highfield Drive. Follow the road round, Emscote can be found on the right hand side.

FLOORPLAN

GROUND FLOOR
1470 sq.ft. (136.5 sq.m.) approx.

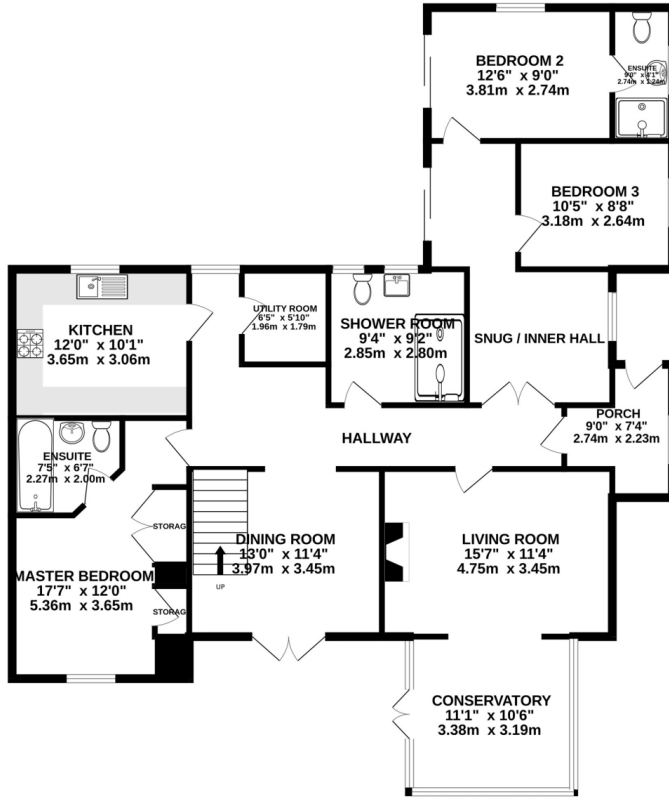

1ST FLOOR
386 sq.ft. (35.9 sq.m.) approx.

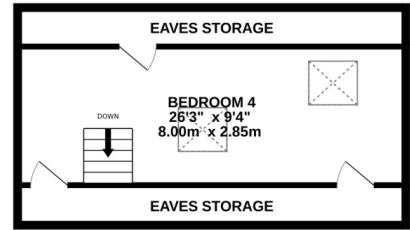

TOTAL FLOOR AREA: 1855 sq.ft. (172.4 sq.m.) approx.

Whilst every attempt has been made to ensure the accuracy of the floorplan contained here, measurements of doors, windows, rooms and any other items are approximate and no responsibility is taken for any error, omission or mis-statement. This plan is for illustrative purposes only and should be used as such by any prospective purchaser. The services, systems and appliances shown have not been tested and no guarantee as to their operability or efficiency can be given.
Made with Metropix ©2023



PROPERTY DETAILS FOR

Emscote, Highfield Drive, Baldrine

Disclaimer

These particulars are for information purposes only and do not constitute or form any contract nor should any statement contained herein be relied upon as a representation of fact.

Neither the vendor nor Black Grace Cowley (the firm), nor any officer or employee of the firm accept liability or responsibility for any statement contained herein.

The vendor does not by these particulars, nor does the firm, nor does any officer or any employee of the firm have any authority to make or give any representation or warranty whatsoever as regards the property or otherwise. It is the sole responsibility of any person interested in the property described in these particulars to make all proper enquiries and searches to verify the description of the property and all other particulars herein.

e: hello@blackgracecowley.com | **w:** blackgracecowley.com | **t:** +44 (0) 1624 645555

a: 51 Victoria Street, DOUGLAS, Isle of Man, IM1 2LD