



ASKING PRICE

£499,950

black
grace
cowley
ESTATE AGENTS

THE DETAILS



4



2



3



7 Gorsecroft

Abbeyfields, Douglas

£499,950

call in today or visit www.blackgracecowley.com for more details

e: hello@blackgracecowley.com | w: blackgracecowley.com | t: +44 (0) 1624 645555

a: 51 Victoria Street, DOUGLAS, Isle of Man, IM1 2LD

PROPERTY DETAILS FOR
7 Gorsecroft, Abbeyfields, Douglas





PROPERTY DETAILS FOR
7 Gorsecroft, Abbeyfields, Douglas



PROPERTY DETAILS FOR
7 Gorsecroft, Abbeyfields, Douglas







PROPERTY DETAILS FOR

7 Gorsecroft, Abbeyfields, Douglas

THE DESCRIPTION

- Beautifully presented 4 bed detached property
- Situated in a popular residential area close to local amenities
- Fully renovated in 2020 including bathrooms and kitchen
- Spacious Living Room, Playroom, Sun Room which is currently used as a dining room
- Modern Kitchen and Utility Room
- Master Bedroom with En-Suite Bathroom, 3 further Bedrooms and Family Bathroom
- Off street parking for 2 cars to the front of the property
- Large wrap around garden with raised patio areas
- uPVC double glazing and oil central heating controlled by a Nest

THE PROPERTY

Black Grace Cowley are delighted to offer this superb four bedroom detached property situated in a popular residential area close to Douglas town centre. The perfect family home comprises a large Living Room, Play Room and Sun Room which is currently used as a Dining Room. The newly fitted modern Kitchen also has a separate Utility Room with access to the rear Garden. Four bedrooms to the first floor, one En-Suite and modern Family Bathroom. The property was fully renovated in 2020 which included new bathrooms, kitchen, utility and floor coverings.

Outside there is off street parking for two vehicles as well as a large wrap around garden with several raised seating areas to take advantage of the sunshine.

Viewing is highly recommended to appreciate all this property has to offer.

e: hello@blackgracecowley.com | **w:** blackgracecowley.com | **t:** +44 (0) 1624 645555

a: 51 Victoria Street, DOUGLAS, Isle of Man, IM1 2LD

FLOORPLAN

GROUND FLOOR
868 sq.ft. (80.6 sq.m.) approx.

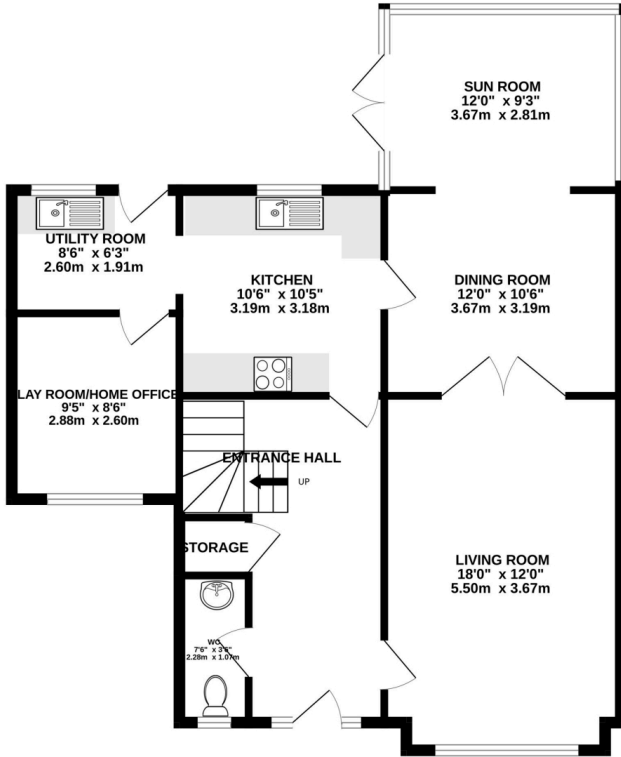

1ST FLOOR
609 sq.ft. (56.5 sq.m.) approx.

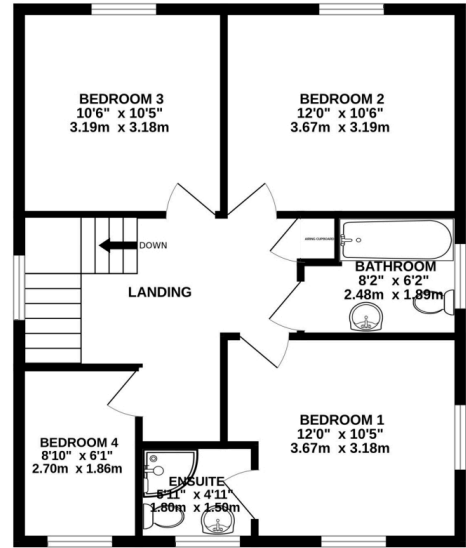

TOTAL FLOOR AREA: 1476 sq.ft. (137.2 sq.m.) approx.

Whilst every attempt has been made to ensure the accuracy of the floorplan contained here, measurements of doors, windows, rooms and any other items are approximate and no responsibility is taken for any error, omission or mis-statement. This plan is for illustrative purposes only and should be used as such by any prospective purchaser. The services, systems and appliances shown have not been tested and no guarantee as to their operability or efficiency can be given.
Made with Metropix ©2024



PROPERTY DETAILS FOR

7 Gorsecroft, Abbeyfields, Douglas

Disclaimer

These particulars are for information purposes only and do not constitute or form any contract nor should any statement contained herein be relied upon as a representation of fact.

Neither the vendor nor Black Grace Cowley (the firm), nor any officer or employee of the firm accept liability or responsibility for any statement contained herein.

The vendor does not by these particulars, nor does the firm, nor does any officer or any employee of the firm have any authority to make or give any representation or warranty whatsoever as regards the property or otherwise. It is the sole responsibility of any person interested in the property described in these particulars to make all proper enquiries and searches to verify the description of the property and all other particulars herein.

e: hello@blackgracecowley.com | **w:** blackgracecowley.com | **t:** +44 (0) 1624 645555

a: 51 Victoria Street, DOUGLAS, Isle of Man, IM1 2LD