



ASKING PRICE

£166,000

THE DETAILS



Apartment 15 Royal Court

Onchan

£166,000

call in today or visit www.blackgracecowley.com for more details

e: hello@blackgracecowley.com | w: blackgracecowley.com | t: +44 (0) 1624 645555

a: 51 Victoria Street, DOUGLAS, Isle of Man, IM1 2LD

Apartment 15 Royal Court, Onchan



Apartment 15 Royal Court, Onchan





PROPERTY DETAILS FOR

Apartment 15 Royal Court, Onchan

THE DESCRIPTION

- Ground floor purpose built apartment
- Investment Opportunity – sold with tenant in situ
- Stones throw away from Onchan Village
- 2 Bedrooms, Family Bathroom
- Open plan Living/Dining/Kitchen
- Gas fired central heating, double glazed
- Communal grounds and ample parking space

THE PROPERTY

Black Grace Cowley are delighted to offer this spacious ground floor purpose built apartment, a stones throw away from Onchan village and amenities. Spacious communal entrance hall with security entry phone and private post boxes. Upon entering Apartment 15, Entrance Hall with built in storage cupboard. Open plan Living/Dining room, Modern Kitchen area with fitted wall and base units. 2 good sized Bedrooms and Family Bathroom with 3-piece suite. Communal grounds with ample parking spaces available. Gas fired central heating. Property is offered for sale with tenant in situ. Leasehold. 192 years remaining, ground rent and interim service charge £1094.94 for 12 month period.

e: hello@blackgracecowley.com | **w:** blackgracecowley.com | **t:** +44 (0) 1624 645555

a: 51 Victoria Street, DOUGLAS, Isle of Man, IM1 2LD

FLOORPLAN

GROUND FLOOR
670 sq.ft. (62.3 sq.m.) approx.

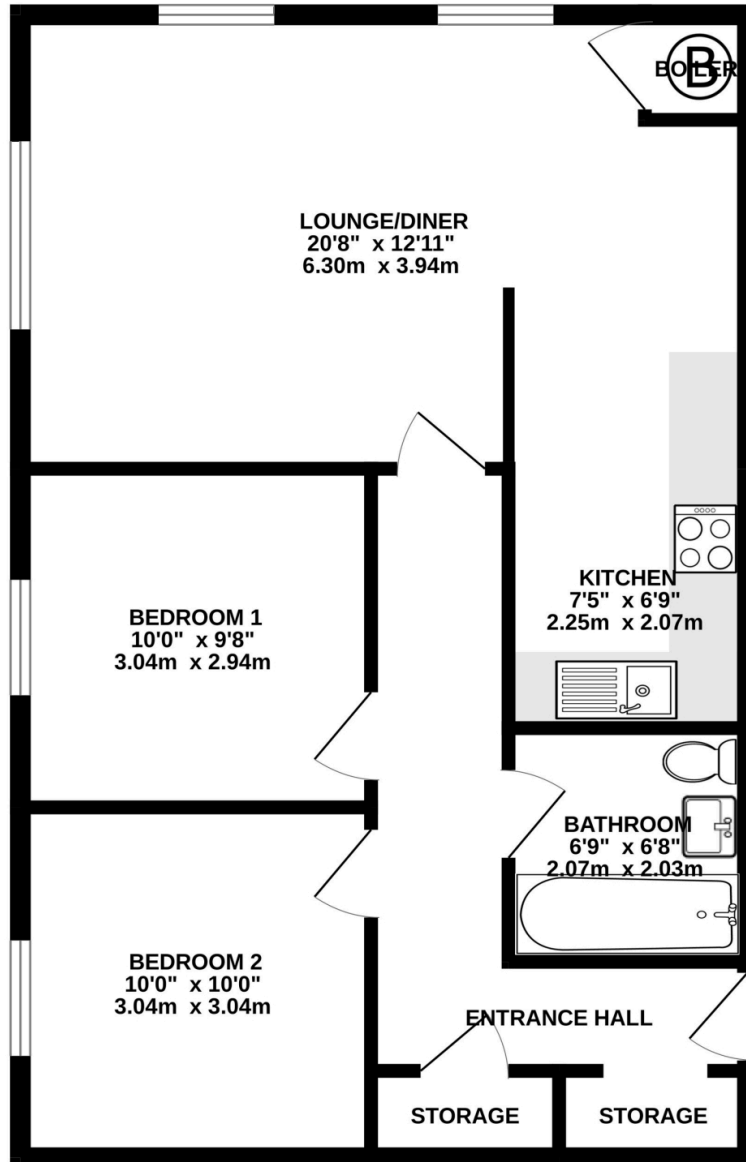

TOTAL FLOOR AREA : 670 sq.ft. (62.3 sq.m.) approx.

Whilst every attempt has been made to ensure the accuracy of the floorplan contained here, measurements of doors, windows, rooms and any other items are approximate and no responsibility is taken for any error, omission or mis-statement. This plan is for illustrative purposes only and should be used as such by any prospective purchaser. The services, systems and appliances shown have not been tested and no guarantee as to their operability or efficiency can be given.
Made with Metropix ©2023

e: hello@blackgracecowley.com | w: blackgracecowley.com | t: +44 (0) 1624 645555

a: 51 Victoria Street, DOUGLAS, Isle of Man, IM1 2LD



PROPERTY DETAILS FOR

Apartment 15 Royal Court, Onchan

Disclaimer

These particulars are for information purposes only and do not constitute or form any contract nor should any statement contained herein be relied upon as a representation of fact.

Neither the vendor nor Black Grace Cowley (the firm), nor any officer or employee of the firm accept liability or responsibility for any statement contained herein.

The vendor does not by these particulars, nor does the firm, nor does any officer or any employee of the firm have any authority to make or give any representation or warranty whatsoever as regards the property or otherwise. It is the sole responsibility of any person interested in the property described in these particulars to make all proper enquiries and searches to verify the description of the property and all other particulars herein.

e: hello@blackgracecowley.com | **w:** blackgracecowley.com | **t:** +44 (0) 1624 645555

a: 51 Victoria Street, DOUGLAS, Isle of Man, IM1 2LD