



ASKING PRICE

£239,000

## THE DETAILS



3



1



1



46 Douglas Street

Peel

£239,000

call in today or visit [www.blackgracecowley.com](http://www.blackgracecowley.com) for more details

e: [peel@blackgracecowley.com](mailto:peel@blackgracecowley.com) | w: [blackgracecowley.com](http://blackgracecowley.com) | t: +44 (0) 1624 845 696

a: 9 Atholl Place, PEEL, Isle of Man, IM5 1HE

PROPERTY DETAILS FOR  
46 Douglas Street, Peel



PROPERTY DETAILS FOR  
46 Douglas Street, Peel



PROPERTY DETAILS FOR  
46 Douglas Street, Peel



PROPERTY DETAILS FOR  
**46 Douglas Street, Peel**





PROPERTY DETAILS FOR

## 46 Douglas Street, Peel

### THE DESCRIPTION

- Mid terraced house
- Conveniently situated in the heart of Peel and only a short walk to schools, shops and local amenities
- Entrance hall
- Lounge/Diner/Kitchen, Utility Room
- 3 Bedrooms, Bathroom
- 2 Useful Attic Rooms
- Rear yard with shed and access

### THE PROPERTY

Black Grace Cowley are pleased to offer 46 Douglas Street to the market. A mid-terraced house situated in the centre of Peel close to shops, local amenities and a short walk to the schools. The front door leads straight into the hallway with access to the lounge/diner/kitchen. There is a utility room off the kitchen and back door to a rear, split-level yard with shed and a back gate to the lane behind. On the first floor are three bedrooms and a bathroom. Stairs on the landing lead to the useful attic rooms on the second floor.

This property is in need of modernisation. Gas fired central heating.

# FLOORPLAN

GROUND FLOOR  
385 sq.ft. (35.8 sq.m.) approx.

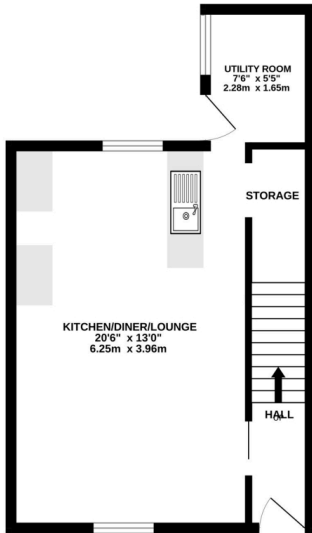

1ST FLOOR  
385 sq.ft. (35.8 sq.m.) approx.

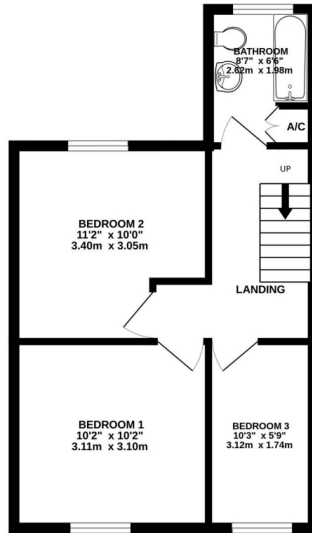

2ND FLOOR  
342 sq.ft. (31.8 sq.m.) approx.

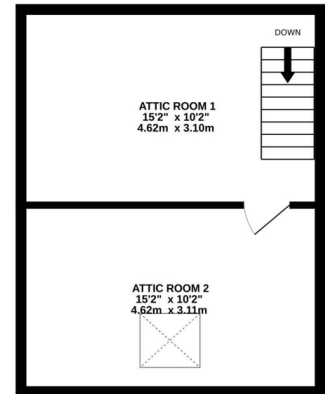

TOTAL FLOOR AREA : 1112 sq.ft. (103.3 sq.m.) approx.

Whilst every attempt has been made to ensure the accuracy of the floorplan contained here, measurements of doors, windows, rooms and any other items are approximate and no responsibility is taken for any error, omission or mis-statement. This plan is for illustrative purposes only and should be used as such by any prospective purchaser. The services, systems and appliances shown have not been tested and no guarantee as to their operability or efficiency can be given.  
Made with Metropix ©2024



PROPERTY DETAILS FOR

46 Douglas Street, Peel

## Disclaimer

These particulars are for information purposes only and do not constitute or form any contract nor should any statement contained herein be relied upon as a representation of fact.

Neither the vendor nor Black Grace Cowley (the firm), nor any officer or employee of the firm accept liability or responsibility for any statement contained herein.

The vendor does not by these particulars, nor does the firm, nor does any officer or any employee of the firm have any authority to make or give any representation or warranty whatsoever as regards the property or otherwise. It is the sole responsibility of any person interested in the property described in these particulars to make all proper enquiries and searches to verify the description of the property and all other particulars herein.

**e:** [peel@blackgracecowley.com](mailto:peel@blackgracecowley.com) | **w:** [blackgracecowley.com](http://blackgracecowley.com) | **t:** +44 (0) 1624 845 696

**a:** 9 Atholl Place, PEEL, Isle of Man, IM5 1HE