



ASKING PRICE

£199,950

black
grace
cowley
ESTATE AGENTS

THE DETAILS



1



1



1



5 Circular Road

Peel

£199,950

call in today or visit www.blackgracecowley.com for more details

e: peel@blackgracecowley.com | w: blackgracecowley.com | t: +44 (0) 1624 845 696

a: 9 Atholl Place, PEEL, Isle of Man, IM5 1HE

PROPERTY DETAILS FOR
5 Circular Road, Peel



PROPERTY DETAILS FOR
5 Circular Road, Peel



PROPERTY DETAILS FOR
5 Circular Road, Peel





PROPERTY DETAILS FOR

5 Circular Road, Peel

THE DESCRIPTION

- Well presented end-terrace house
- Conveniently situated in the heart of Peel and within walking distance to the beach, shops and local amenities
- Lounge/diner, Kitchen
- 1 Double Bedroom, Bathroom, Attic Room, walk-in Storage Cupboard
- Enclosed rear yard with hill and sea views
- uPVC double glazed, Gas Central Heating
- Offered for sale with no onward chain

THE PROPERTY

Black Grace Cowley are pleased to offer 5 Circular Road to the market, a well presented end-terrace house. Located in the heart of Peel within walking distance to the beach, marina, shops, bus route and local amenities. A short drive to Douglas, Ramsey and South of the Island. Entering the property through the uPVC double glazed door into the porch which leads into the hall/dining area with stairs to the upper floors. At the front is a cosy lounge. Off the dining room is the kitchen which is fitted with a comprehensive range of base and wall units with integrated AEG appliances; fridge/freezer, double oven, induction hob, slim-line dishwasher, single fridge and plumbing for washing machine and dryer. On the first floor is a double bedroom, walk-in storage cupboard, bathroom and stairs leading to a large attic room with Velux windows.

At the rear of the property is a good sized yard with views towards Peel Hill and the sea.

Gas fired central heating. uPVC double glazed.

e: peel@blackgracecowley.com | **w:** blackgracecowley.com | **t:** +44 (0) 1624 845 696

a: 9 Atholl Place, PEEL, Isle of Man, IM5 1HE

FLOORPLAN

GROUND FLOOR
383 sq.ft. (35.6 sq.m.) approx.

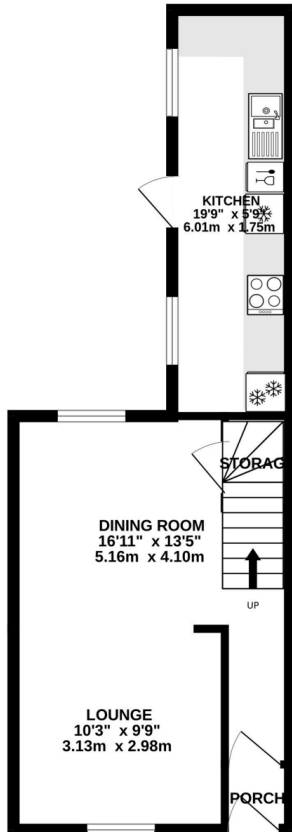

1ST FLOOR
270 sq.ft. (25.1 sq.m.) approx.

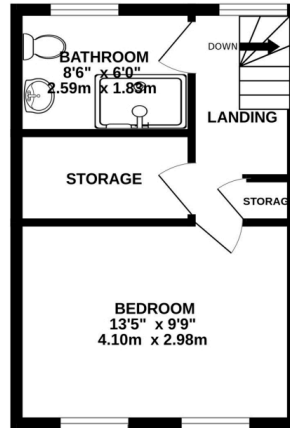

2ND FLOOR
256 sq.ft. (23.8 sq.m.) approx.

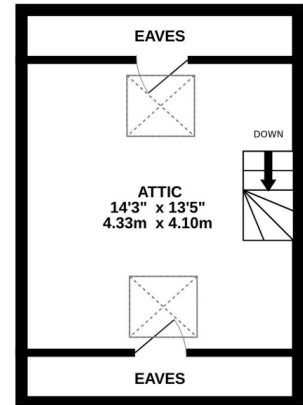

TOTAL FLOOR AREA : 909 sq.ft. (84.5 sq.m.) approx.

Whilst every attempt has been made to ensure the accuracy of the floorplan contained here, measurements of doors, windows, rooms and any other items are approximate and no responsibility is taken for any error, omission or mis-statement. This plan is for illustrative purposes only and should be used as such by any prospective purchaser. The services, systems and appliances shown have not been tested and no guarantee as to their operability or efficiency can be given.

Made with Metropix ©2024



PROPERTY DETAILS FOR

5 Circular Road, Peel

Disclaimer

These particulars are for information purposes only and do not constitute or form any contract nor should any statement contained herein be relied upon as a representation of fact.

Neither the vendor nor Black Grace Cowley (the firm), nor any officer or employee of the firm accept liability or responsibility for any statement contained herein.

The vendor does not by these particulars, nor does the firm, nor does any officer or any employee of the firm have any authority to make or give any representation or warranty whatsoever as regards the property or otherwise. It is the sole responsibility of any person interested in the property described in these particulars to make all proper enquiries and searches to verify the description of the property and all other particulars herein.

e: peel@blackgracecowley.com | **w:** blackgracecowley.com | **t:** +44 (0) 1624 845 696

a: 9 Atholl Place, PEEL, Isle of Man, IM5 1HE