



ASKING PRICE

£235,000



## THE DETAILS



2



2



1



Apartment 1

Marina House, Marine Parade, Peel

£235,000

call in today or visit [www.blackgracecowley.com](http://www.blackgracecowley.com) for more details

e: [peel@blackgracecowley.com](mailto:peel@blackgracecowley.com) | w: [blackgracecowley.com](http://blackgracecowley.com) | t: +44 (0) 1624 845 696

a: 9 Atholl Place, PEEL, Isle of Man, IM5 1HE



# Apartment 1, Marina House, Marine Parade, Peel













# Apartment 1, Marina House, Marine Parade, Peel





# Apartment 1, Marina House, Marine Parade, Peel





PROPERTY DETAILS FOR

## Apartment 1, Marina House, Marine Parade, Peel

### THE DESCRIPTION

- Well presented garden apartment enjoying sea and coastal views
- Peel Beach and Marina are on your doorstep, with shops and local amenities only a short walk away
- Open plan kitchen/diner/lounge with wood burner
- 2 Bedrooms, En-suite, Bathroom
- Front garden and Rear Yard
- Viewings highly recommended

### THE PROPERTY

Black Grace Cowley are pleased to offer Apartment 1 Marina House to the market, a well presented garden apartment enjoying uninterrupted sea and coastal views. Featuring an entrance porch which leads into the modern open plan kitchen/diner/lounge with a log burner and uPVC French doors leading to the patio. The kitchen area is fitted with a stylish shaker kitchen with integrated appliances and a contrasting blue island with wood worksurfaces incorporating storage and a breakfast bar. Off the living space is a rear hall with storage and providing access to the master bedroom, en-suite bathroom with utility area and large storage cupboard, the second double bedroom and a modern shower room. Access to the rear can be sought from both bedrooms.

At the front of the property is a paved, low maintenance garden with views of the sea, Peel Castle and coastline. At the rear is a small yard with a storage shed, stairs lead up to the well maintained shared paved garden.

Gas fired central heating. uPVC double glazed.

**e:** [peel@blackgracecowley.com](mailto:peel@blackgracecowley.com) | **w:** [blackgracecowley.com](http://blackgracecowley.com) | **t:** +44 (0) 1624 845 696

**a:** 9 Atholl Place, PEEL, Isle of Man, IM5 1HE

# FLOORPLAN

GROUND FLOOR  
1032 sq.ft. (95.9 sq.m.) approx.

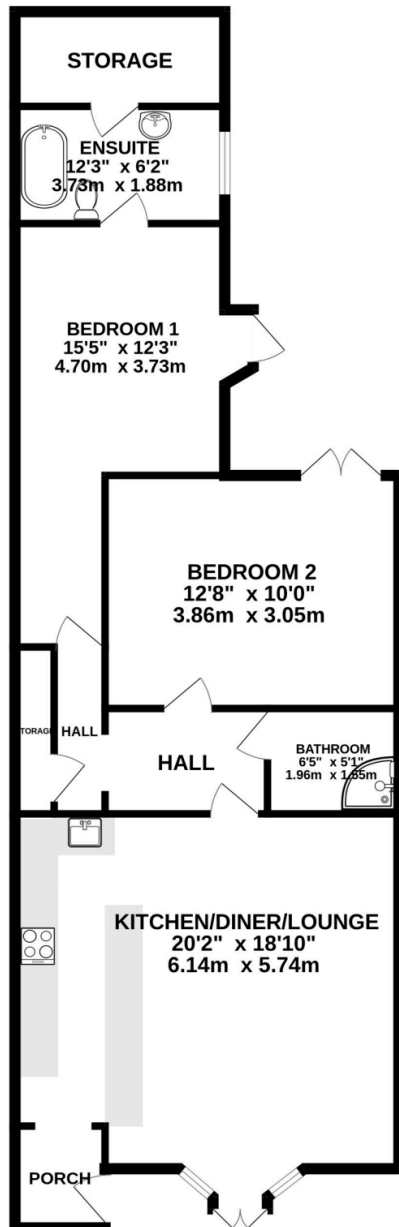

TOTAL FLOOR AREA : 1032 sq.ft. (95.9 sq.m.) approx.

Whilst every attempt has been made to ensure the accuracy of the floorplan contained here, measurements of doors, windows, rooms and any other items are approximate and no responsibility is taken for any error, omission or mis-statement. This plan is for illustrative purposes only and should be used as such by any prospective purchaser. The services, systems and appliances shown have not been tested and no guarantee as to their operability or efficiency can be given.  
Made with Metropix ©2024





PROPERTY DETAILS FOR

# Apartment 1, Marina House, Marine Parade, Peel

## Disclaimer

These particulars are for information purposes only and do not constitute or form any contract nor should any statement contained herein be relied upon as a representation of fact.

Neither the vendor nor Black Grace Cowley (the firm), nor any officer or employee of the firm accept liability or responsibility for any statement contained herein.

The vendor does not by these particulars, nor does the firm, nor does any officer or any employee of the firm have any authority to make or give any representation or warranty whatsoever as regards the property or otherwise. It is the sole responsibility of any person interested in the property described in these particulars to make all proper enquiries and searches to verify the description of the property and all other particulars herein.

**e:** [peel@blackgracecowley.com](mailto:peel@blackgracecowley.com) | **w:** [blackgracecowley.com](http://blackgracecowley.com) | **t:** +44 (0) 1624 845 696

**a:** 9 Atholl Place, PEEL, Isle of Man, IM5 1HE