



ASKING PRICE

£129,000



THE DETAILS



1



1



1



Apartment 6 Atholl Buildings
Peel, Isle of Man
£129,000

call in today or visit www.blackgracecowley.com for more details

e: peel@blackgracecowley.com | w: blackgracecowley.com | t: +44 (0) 1624 845 696

a: 9 Atholl Place, PEEL, Isle of Man, IM5 1HE

PROPERTY DETAILS FOR
Apartment 6 Atholl Buildings



e: peel@blackgracecowley.com | w: blackgracecowley.com | t: +44 (0) 1624 845 696

a: 9 Atholl Place, PEEL, Isle of Man, IM5 1HE

PROPERTY DETAILS FOR Apartment 6 Atholl Buildings



e: peel@blackgracecowley.com | w: blackgracecowley.com | t: +44 (0) 1624 845 696

a: 9 Atholl Place, PEEL, Isle of Man, IM5 1HE

Apartment 6 Atholl Buildings



Apartment 6 Atholl Buildings

THE DESCRIPTION

- Purpose built 2nd Floor Apartment
- Situated in the centre of Peel and walking distance to shops, the promenade and all amenities
- Lounge, Kitchen, Bathroom
- Spacious Double Bedroom
- Gas Central Heating
- No onward chain

THE PROPERTY

Black Grace Cowley are pleased to bring Apartment 6 Atholl Buildings to the market. Situated in the heart of Peel, just a short walk from the shops, restaurants, promenade and marina. This delightful second-floor, one-bedroom apartment offers deceptively spacious accommodation. The apartment features a bright dual-aspect lounge with sunny views overlooking the harbour wall and sea, a good-sized kitchen with an electric oven, base and wall units with integrated washing machine and fridge. A spacious double bedroom, and a family bathroom.

Gas central heating. uPVC double glazing throughout. Active management company.

FLOORPLAN

GROUND FLOOR
550 sq.ft. (51.1 sq.m.) approx.

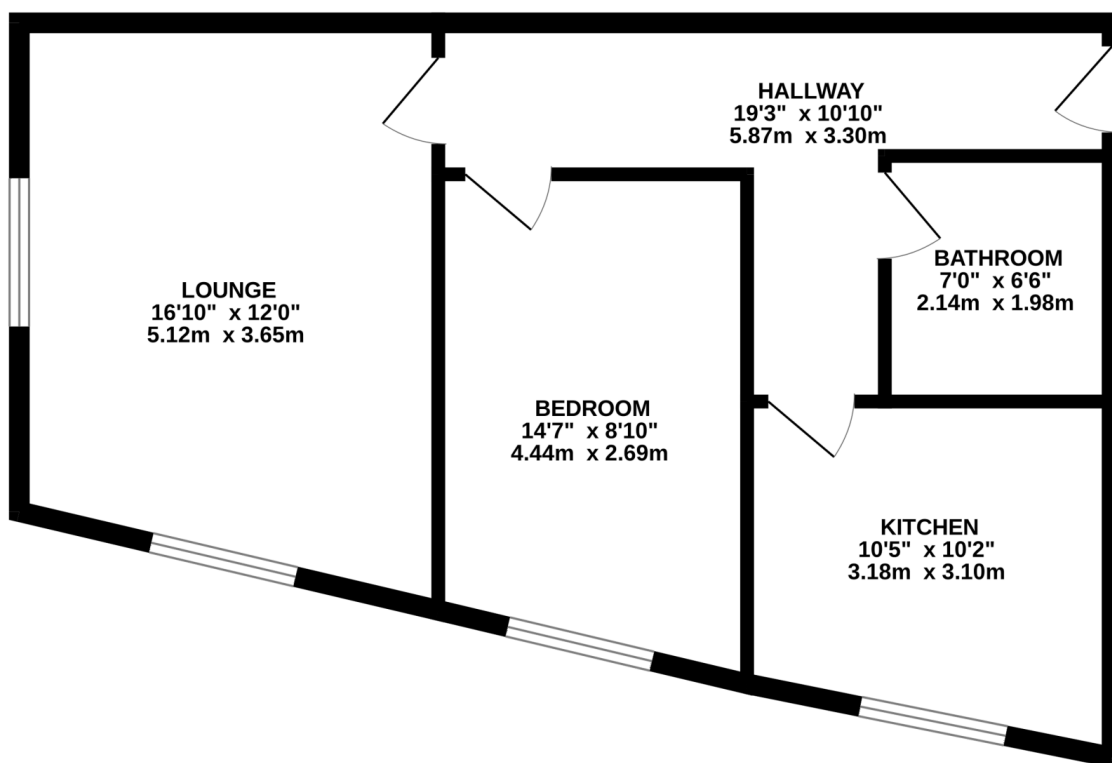

TOTAL FLOOR AREA : 550 sq.ft. (51.1 sq.m.) approx.
Whilst every attempt has been made to ensure the accuracy of the floorplan contained here, measurements of doors, windows, rooms and any other items are approximate and no responsibility is taken for any error, omission or mis-statement. This plan is for illustrative purposes only and should be used as such by any prospective purchaser. The services, systems and appliances shown have not been tested and no guarantee as to their operability or efficiency can be given.
Made with Metropix ©2025



PROPERTY DETAILS FOR

Apartment 6 Atholl Buildings

Disclaimer

These particulars are for information purposes only and do not constitute or form any contract nor should any statement contained herein be relied upon as a representation of fact.

Neither the vendor nor Black Grace Cowley (the firm), nor any officer or employee of the firm accept liability or responsibility for any statement contained herein.

The vendor does not by these particulars, nor does the firm, nor does any officer or any employee of the firm have any authority to make or give any representation or warranty whatsoever as regards the property or otherwise. It is the sole responsibility of any person interested in the property described in these particulars to make all proper enquiries and searches to verify the description of the property and all other particulars herein.

e: peel@blackgracecowley.com | **w:** blackgracecowley.com | **t:** +44 (0) 1624 845 696

a: 9 Atholl Place, PEEL, Isle of Man, IM5 1HE