



ASKING PRICE

£135,000



THE DETAILS



2



1



1



Flat 2

1 Woodburn Square, Douglas

£135,000

call in today or visit www.blackgracecowley.com for more details

e: hello@blackgracecowley.com | w: blackgracecowley.com | t: +44 (0) 1624 645555

a: 51 Victoria Street, DOUGLAS, Isle of Man, IM1 2LD

THE DESCRIPTION

- First Floor Flat situated in Central Douglas
- Lounge/Diner, Kitchen, 2 Bedrooms, 1 Bathroom
- Separate Store Room
- Shared Private Rear Courtyard Garden
- Double glazed throughout, Gas Central Heating
- Requires modernisation throughout
- No onward chain

THE PROPERTY

Black Grace Cowley are pleased to offer Flat 2, 1 Woodburn Square to the market. The apartment is situated on the first floor and requires modernisation throughout. The flat comprises of an excellent sized lounge overlooking Woodburn Square, fitted galley style kitchen with wall mounted gas boiler. 2 double bedrooms, family bathroom plus additional storeroom with space and plumbing for washing machine, could be utilised as a laundry room.

Communal areas are well maintained, with three flats within the block. The flat is situated within easy walking distance of Douglas Town Centre and just across the road from the terrace.

Offered for sale with no onward chain.

FLOORPLAN

GROUND FLOOR
789 sq.ft. (73.3 sq.m.) approx.

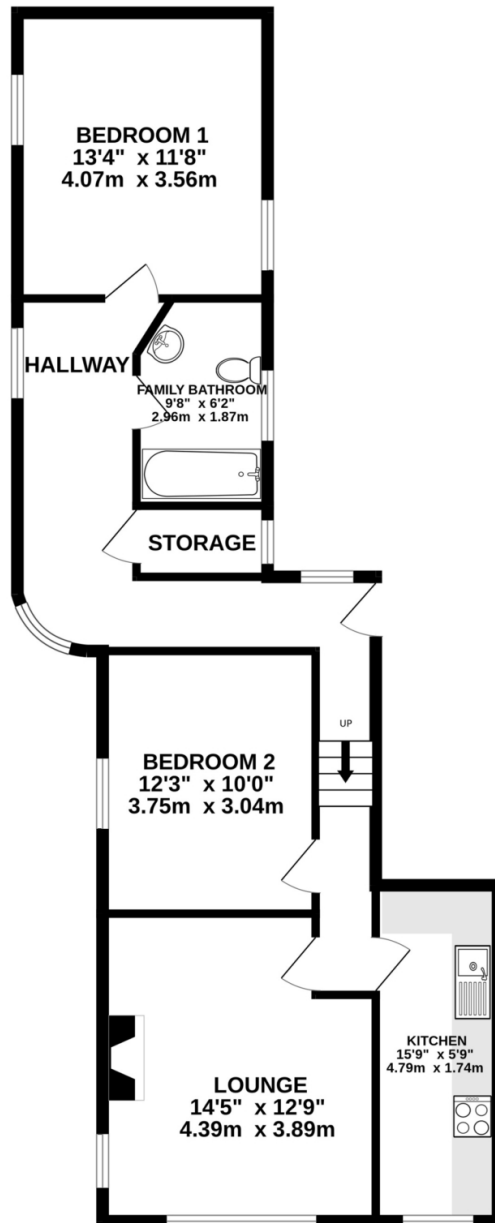

TOTAL FLOOR AREA : 789 sq.ft. (73.3 sq.m.) approx.

Whilst every attempt has been made to ensure the accuracy of the floorplan contained here, measurements of doors, windows, rooms and any other items are approximate and no responsibility is taken for any error, omission or mis-statement. This plan is for illustrative purposes only and should be used as such by any prospective purchaser. The services, systems and appliances shown have not been tested and no guarantee as to their operability or efficiency can be given.
Made with Metropix ©2025



PROPERTY DETAILS FOR

Flat 2, 1 Woodburn Square, Douglas

Disclaimer

These particulars are for information purposes only and do not constitute or form any contract nor should any statement contained herein be relied upon as a representation of fact.

Neither the vendor nor Black Grace Cowley (the firm), nor any officer or employee of the firm accept liability or responsibility for any statement contained herein.

The vendor does not by these particulars, nor does the firm, nor does any officer or any employee of the firm have any authority to make or give any representation or warranty whatsoever as regards the property or otherwise. It is the sole responsibility of any person interested in the property described in these particulars to make all proper enquiries and searches to verify the description of the property and all other particulars herein.

e: hello@blackgracecowley.com | **w:** blackgracecowley.com | **t:** +44 (0) 1624 645555

a: 51 Victoria Street, DOUGLAS, Isle of Man, IM1 2LD