



ASKING PRICE

£1,050,000



THE DETAILS

 5  3  5



Mill House

Foxdale Road, St Johns

£1,050,000

call in today or visit www.blackgracecowley.com for more details

e: hello@blackgracecowley.com | w: blackgracecowley.com | t: +44 (0) 1624 645555

a: 51 Victoria Street, DOUGLAS, Isle of Man, IM1 2LD

PROPERTY DETAILS FOR
Mill House, Foxdale Road, St Johns







PROPERTY DETAILS FOR
Mill House, Foxdale Road, St Johns



PROPERTY DETAILS FOR
Mill House, Foxdale Road, St Johns



Mill House, Foxdale Road, St Johns





Mill House, Foxdale Road, St Johns





Mill House, Foxdale Road, St Johns



THE DESCRIPTION

- Detached residence extending to approx. 3,500 sq ft
- Close to 4 acres of private grounds
- River Neb running through the gardens
- Private meadow extending to approx. 2 acres
- Views towards Slieau Whallian
- Large open-plan kitchen and family space
- Multiple reception rooms
- Up to 6 bedrooms
- Principal en-suite
- Detached double garage
- Extensive private parking
- 15 minutes to Douglas and Ronaldsway Airport
- 5 minutes to Peel and the west coast beaches

THE PROPERTY

A substantial detached residence extending to approximately 3,500 sq ft, set within close to 4 acres of private grounds in the heart of St John's.

Positioned behind a winding private driveway, Mill House enjoys a rare combination of privacy, land and accessibility. The River Neb runs through the gardens, with open lawns, mature woodland and a private meadow of approximately 2 acres, all enjoying views towards Slieau Whallian.

The accommodation is well balanced and versatile, centred around a large open-plan kitchen and family space, with separate reception rooms providing a more traditional feel. There are up to 6 bedrooms, including 5 first floor doubles, together with generous bathroom accommodation and a principal en-suite.

Douglas, Ronaldsway Airport and King William's College are all within 15 minutes, St. John's primary and the Bunscoil are on the doorstep, with Peel and the west coast just 5 minutes away.

A private country setting in one of the Island's most central and convenient locations.

FLOORPLAN

GROUND FLOOR
2197 sq.ft. (204.1 sq.m.) approx.

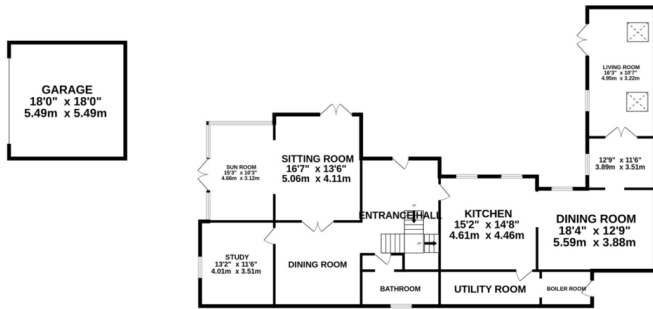

1ST FLOOR
1657 sq.ft. (154.0 sq.m.) approx.

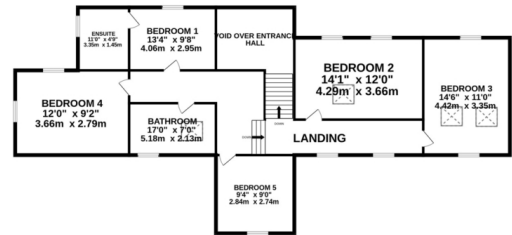

TOTAL FLOOR AREA: 3854 sq.ft. (358.1 sq.m.) approx.

Whilst every attempt has been made to ensure the accuracy of the floorplan contained here, measurements of doors, windows, rooms and any other items are approximate and no responsibility is taken for any error, omission or mis-statement. This plan is for illustrative purposes only and should be used as such by any prospective purchaser. The services, systems and appliances shown have not been tested and no guarantee as to their operability or efficiency can be given.
Made with Metropix ©2026



PROPERTY DETAILS FOR

Mill House, Foxdale Road, St Johns

Disclaimer

These particulars are for information purposes only and do not constitute or form any contract nor should any statement contained herein be relied upon as a representation of fact.

Neither the vendor nor Black Grace Cowley (the firm), nor any officer or employee of the firm accept liability or responsibility for any statement contained herein.

The vendor does not by these particulars, nor does the firm, nor does any officer or any employee of the firm have any authority to make or give any representation or warranty whatsoever as regards the property or otherwise. It is the sole responsibility of any person interested in the property described in these particulars to make all proper enquiries and searches to verify the description of the property and all other particulars herein.

e: hello@blackgracecowley.com | **w:** blackgracecowley.com | **t:** +44 (0) 1624 645555

a: 51 Victoria Street, DOUGLAS, Isle of Man, IM1 2LD